

Recommended Design Concept C

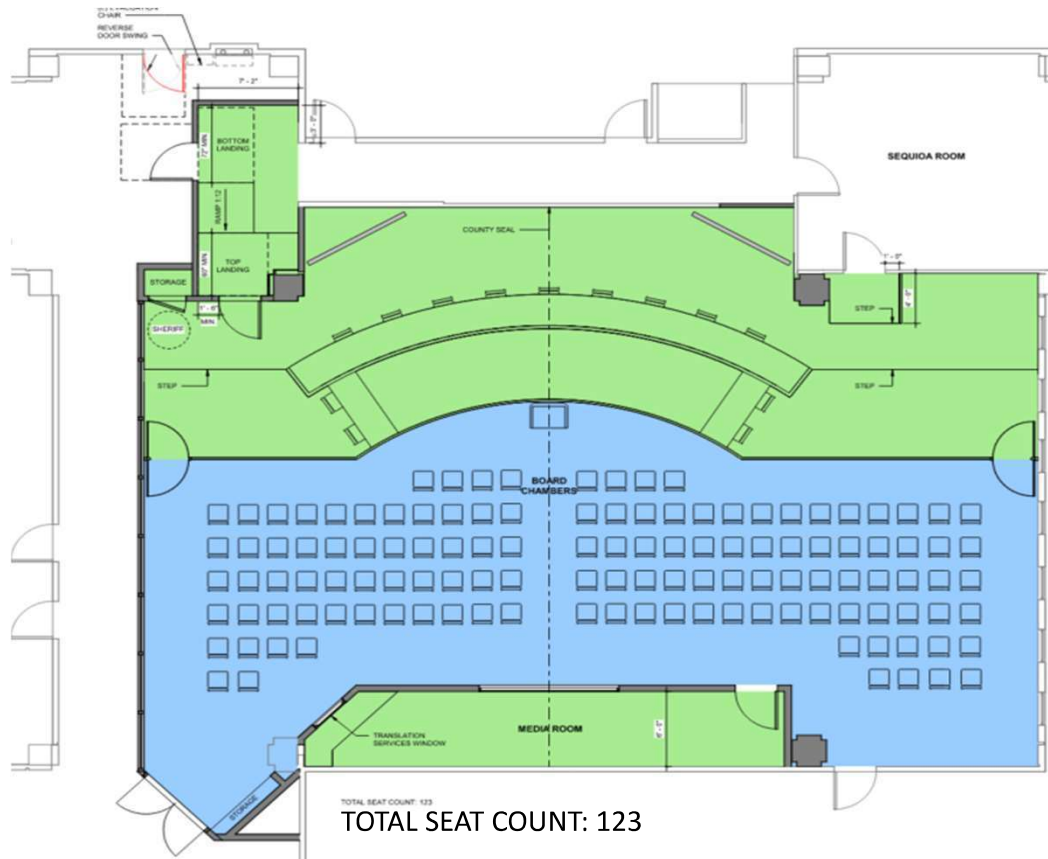

- Reorientation of the room
 - First opportunity since late 1960's.
- Enhanced safety
 - Additional exits for Board and public
- Natural Light
 - The curtains can be open
- Increased area and seating
 - Minimize overflow into the hall

NET SQUARE FOOT (NSF) COMPARISON - OPTION C		
ROOM NAME	EXISTING NSF	NEW NSF
BOARD CHAMBERS	2112 NSF	2490 NSF
MEDIA ROOM	110 NSF	198 NSF
LITTLE BASIN (OFFICE)	49 NSF	0 NSF
SEQUIOA ROOM (NIC)	312 NSF	312 NSF

Recommended Design Concept C1 (diagonal seating)

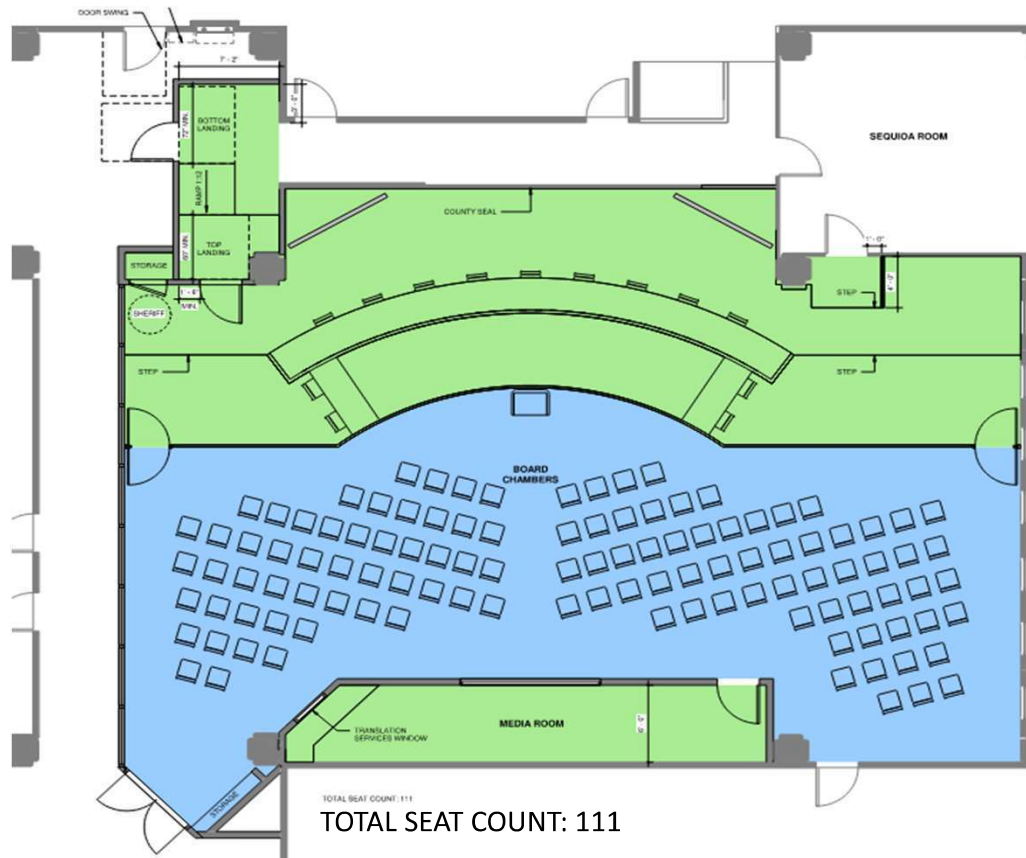

- Reorientation of the room
 - First opportunity since late 1960's.
- Enhanced safety
 - Additional exits for Board and public
- Natural Light
 - The curtains can be open
- Increased area and seating
 - Minimize overflow into the hall

NET SQUARE FOOT (NSF) COMPARISON - OPTION C		
ROOM NAME	EXISTING NSF	NEW NSF
BOARD CHAMBERS	2112 NSF	2490 NSF
MEDIA ROOM	110 NSF	198 NSF
LITTLE BASIN (OFFICE)	49 NSF	0 NSF
SEQUIOA ROOM (NIC)	312 NSF	312 NSF

Design Concept C – 3D Rendering



Design Concept C – 3D Rendering



Design Concept C – 3D Rendering



Design Concept C – 3D Rendering



Alternate Design Concept A

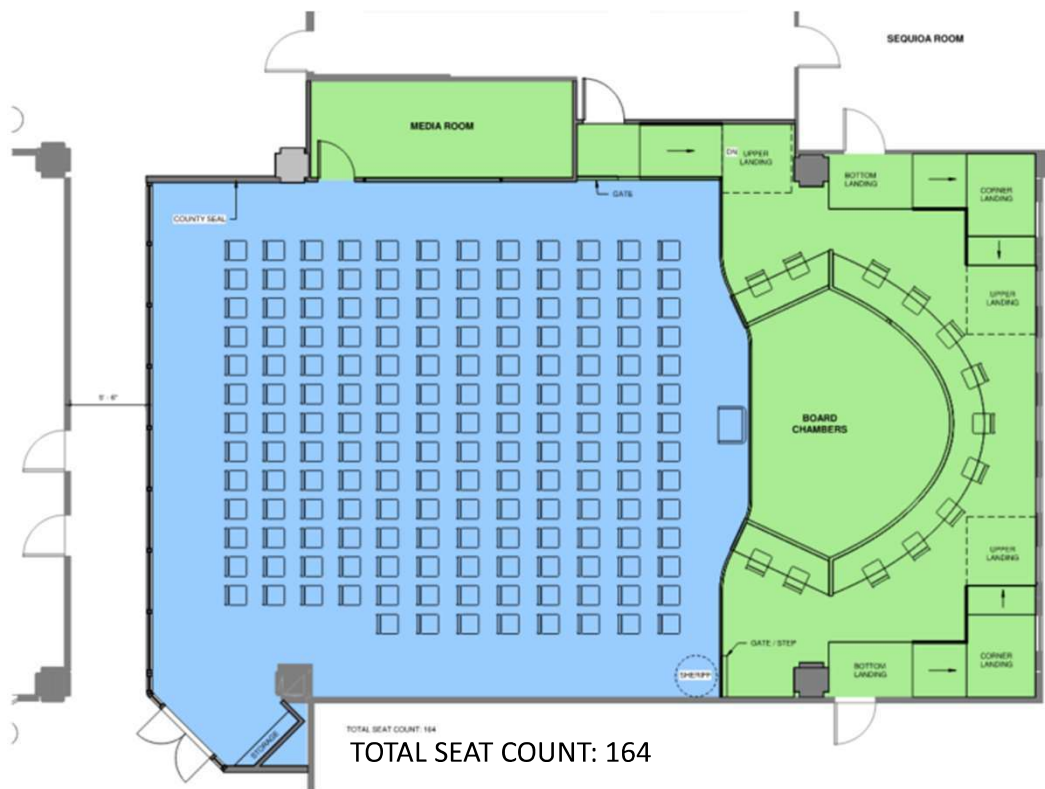

- Maintains historic room layout
- No Natural Light
 - The curtains remain closed during broadcasting
- Increased area and seating
 - Minimize overflow into the hall
- No additional exits for enhanced security

NET SQUARE FOOT (NSF) COMPARISON - OPTION A		
ROOM NAME	EXISTING NSF	NEW NSF
BOARD CHAMBERS	2112 NSF	2509 NSF
MEDIA ROOM	110 NSF	133 NSF
LITTLE BASIN (OFFICE)	49 NSF	0 NSF
SEQUIOA ROOM (NIC)	312 NSF	312 NSF

Design Concept A – 3D Rendering



Design Concept A – 3D Rendering



